

How to Sign Into Chrome

Signing into Chrome is a great way to carry over bookmarks, saved passwords, search history, and all other Google related settings across multiple devices and platforms.

Step 1: Open Chrome and find the person icon on the top right.

If you're on a Windows computer:

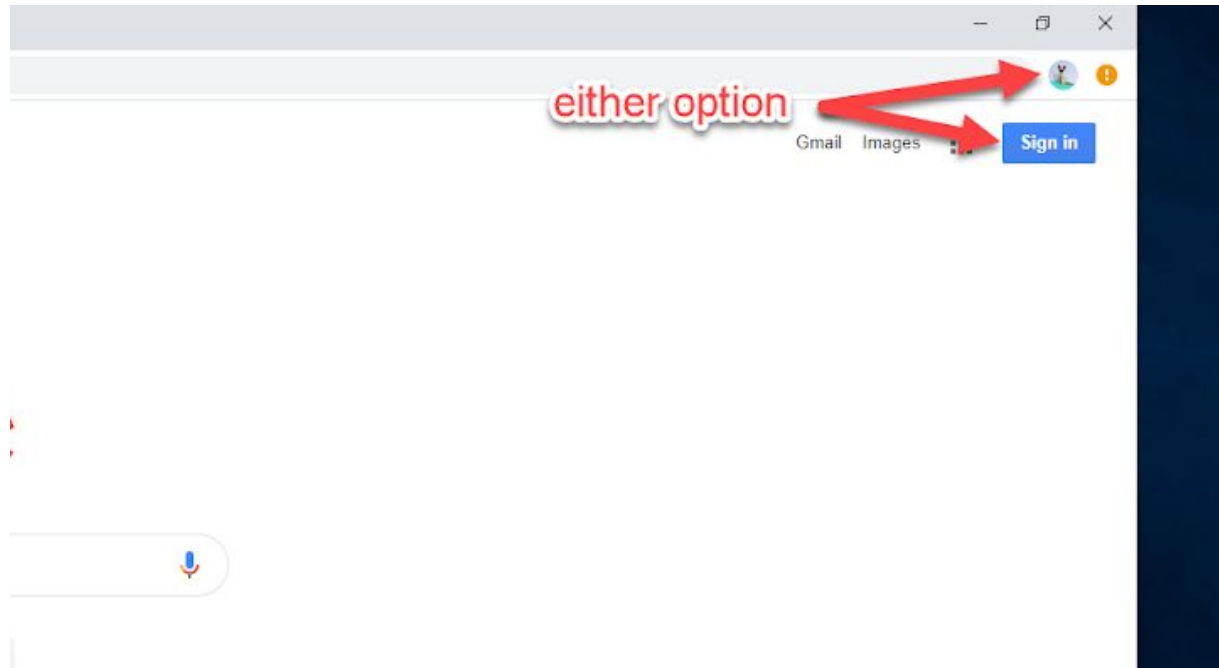

If you're on a Mac:

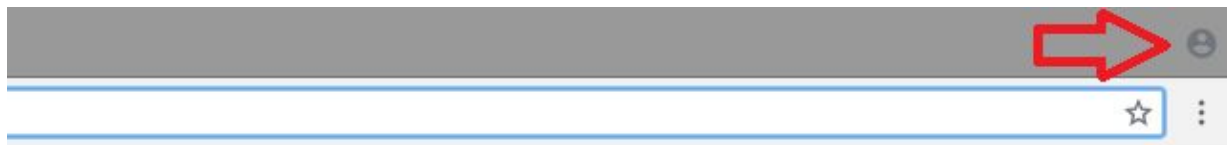

Mail Images   

le



Step 2: Click the icon to bring up a menu and click the option “Sign in to Chrome”.

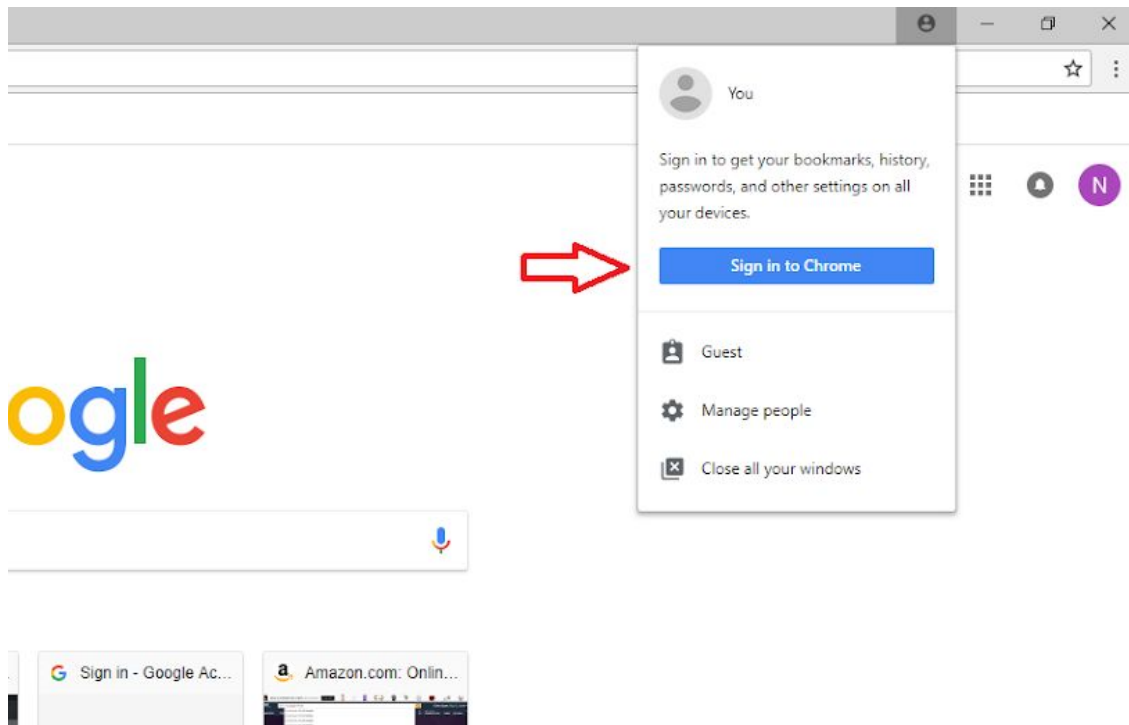

Step 3: Enter the login credentials of the account you want to sync. This will take you to a final menu where you must click the “Link Data” button.

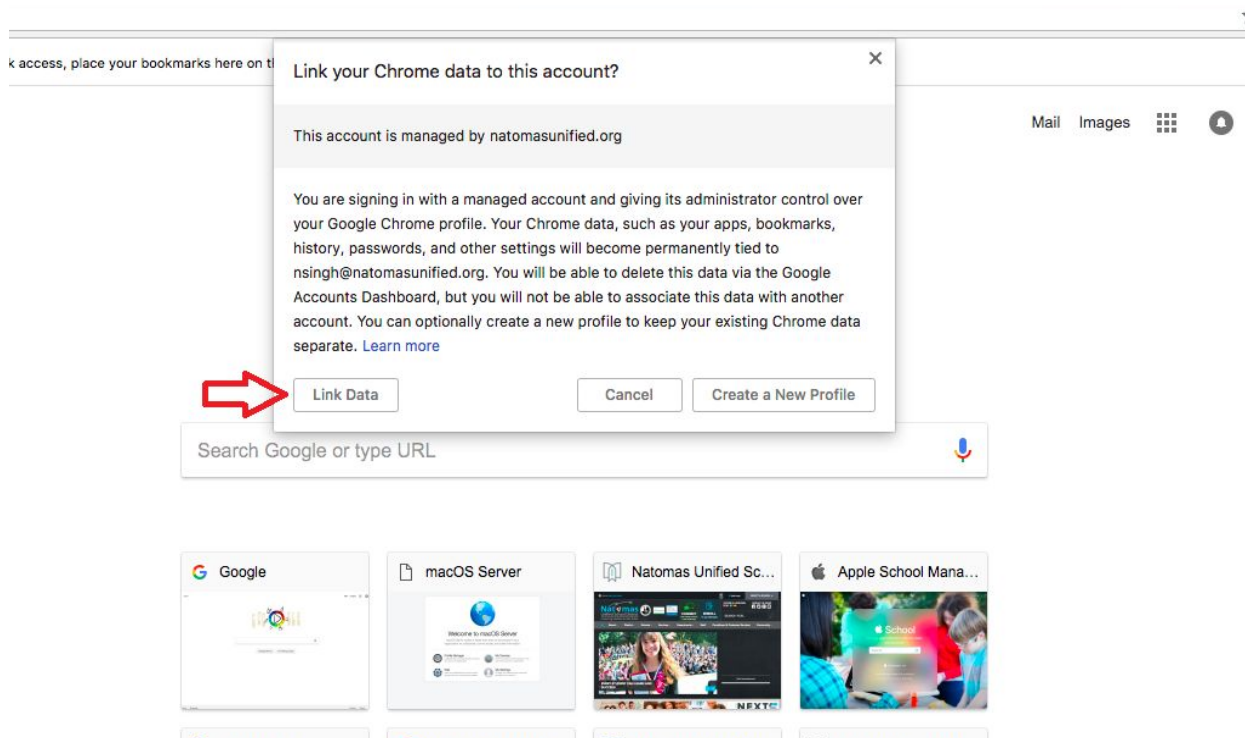

That's it! Click OK though all following menus and your sync will be set and ready to go.

In order to include other devices into the Chrome sync, simply repeat the above steps on the desired device.

Still having issues? Visit our [help desk](#) for some personal assistance.